



 the
ACCOMMODATION
BUREAU

 the
ACCOMMODATION
BUREAU

£600 Per Calendar Month
Fernleigh Gardens, Wadebridge, PL27

 1  1  1  C



Property Description

First floor studio apartment located on a quiet development within walking distance of town centre.

This newly decorated and re-carpeted studio flat consists of: private entrance with stairs up to first floor. Open plan lounge/kitchen/diner. Kitchen includes built-in electric cooker and space for fridge. Hallway with storage cupboard & plumbing for washing machine. Opaque glazed doors lead from the lounge to the bedroom area with built-in wardrobes. Bathroom with electric shower over bath. There is an electric panel heater in the lounge and also allocated parking.

Energy Rating C (73). Council Tax Band A. Deposit £690. Sorry no children, pets or smokers.

Floorplan

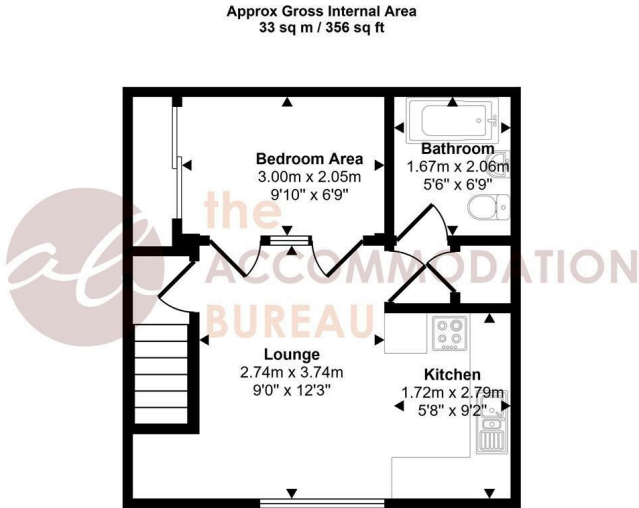

Floorplan

This floorplan is only for illustrative purposes and is not to scale. Measurements of rooms, doors, windows, and any items are approximate and no responsibility is taken for any error, omission or mis-statement. Icons of items such as bathroom suites are representations only and may not look like the real items. Made with Made Snappy 360.

Location

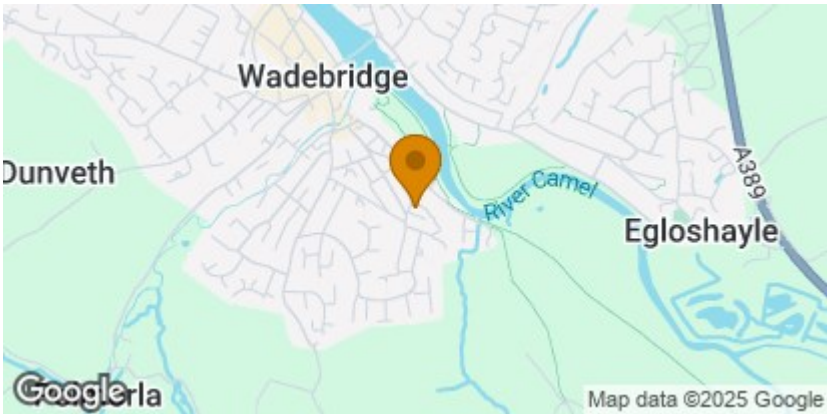

Features

Quiet development location
Re-decorated with new carpets
Open-plan lounge/kitchen
Built-in wardrobes
Allocated parking
EPC Rating C (73)
Council Tax Band A

Letting Information

Rent: £600 Per Calendar Month
Holding Deposit: £100
Total Deposit Required: £690
Local Authority: Cornwall Council
Council Tax Band: A
Furnishing: Unfurnished
Available From: 18th December 2025

Energy Efficiency Rating

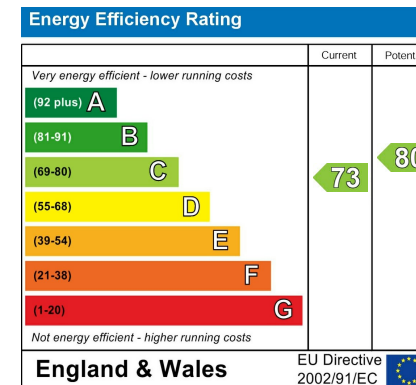

For further information, please call The Accommodation Bureau on 01208 78480.

7 Turf Street, Bodmin, PL31 2DJ. bodmin@theaccommodationbureau.com.

These particulars, whilst believed to be accurate are set out as a general outline only for guidance and do not constitute any part of an offer or contract. Prospective tenants should not rely on them as statements of representation of fact, but must satisfy themselves by inspection or otherwise as to their accuracy. No person in this firm's employment has the authority to make or give any representation or warranty in respect of the property.

